

## Horizontal Grill mod GHPI 2/600

**Dimensions:**

29,52" (w) x 33,48" (h) x 30,24" (p)

**Weight:** 140 kg

**Thermal Flow:** 24,2 kw

**Type:** A

**Category:** II<sub>2H3+</sub>

**Voltage:** 230 V

**Electric Power:** 0,6 w

**Butane gas**

Pressure - 28-30 mbar

Consumption - 1,9 kg/h

**Propane gas**

Pressure - 37 mbar

Consumption - 1,9 kg/h

**Natural gas**

Pressure - 20 mbar

Consumption - 2,6 m<sup>3</sup>/h

*Built in available*



without feet



scraper

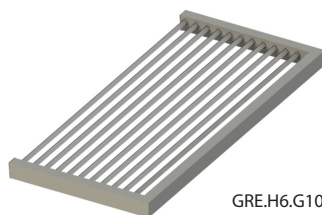

GRE.H6.G10  
half grid

Horizontal Grill mod GHPI **2/600**

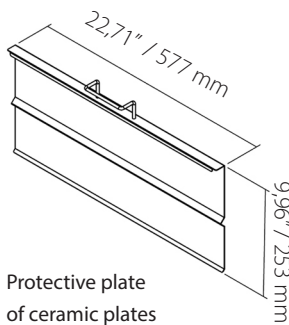
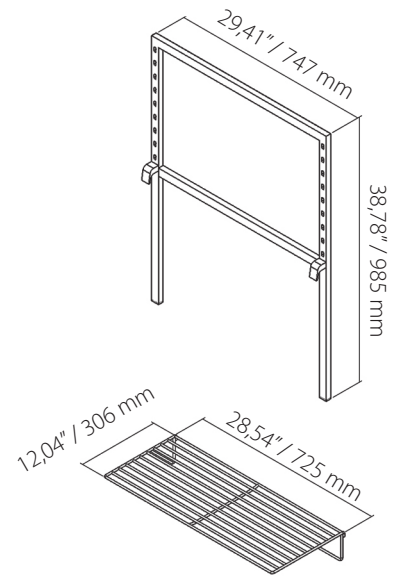
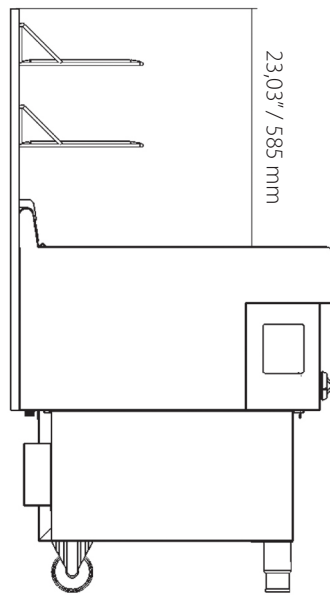
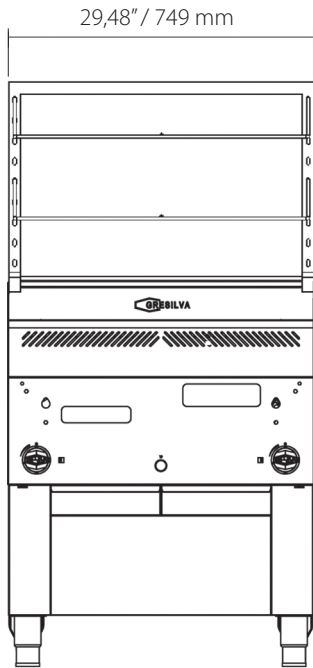
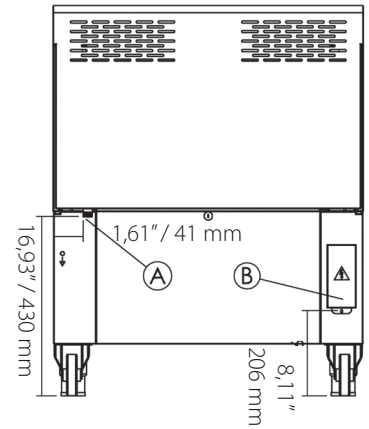
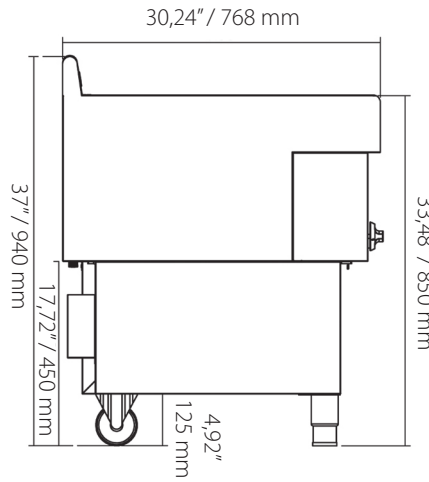
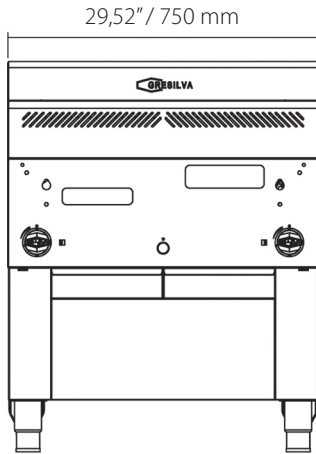

Protective plate  
of ceramic plates

